

KIMLEY-HORN AND ASSOCIATES, INC. 2017 TRAFFIC DETOUR PLAN - PHASE 1
NOVEMBER 2017
SCALE: AS SHOWN
DESIGNED BY: KHA
DRAWN BY: DSC
CHECKED BY: NJM
DATE: 11/14/2017

This document, together with the concepts and designs presented herein, is intended only for the specific purpose and site for which it was prepared. Review of and approval of this document without written authorization and adaptation by Kimley-Horn and Associates, Inc. shall be without liability to Kimley-Horn and Associates, Inc.

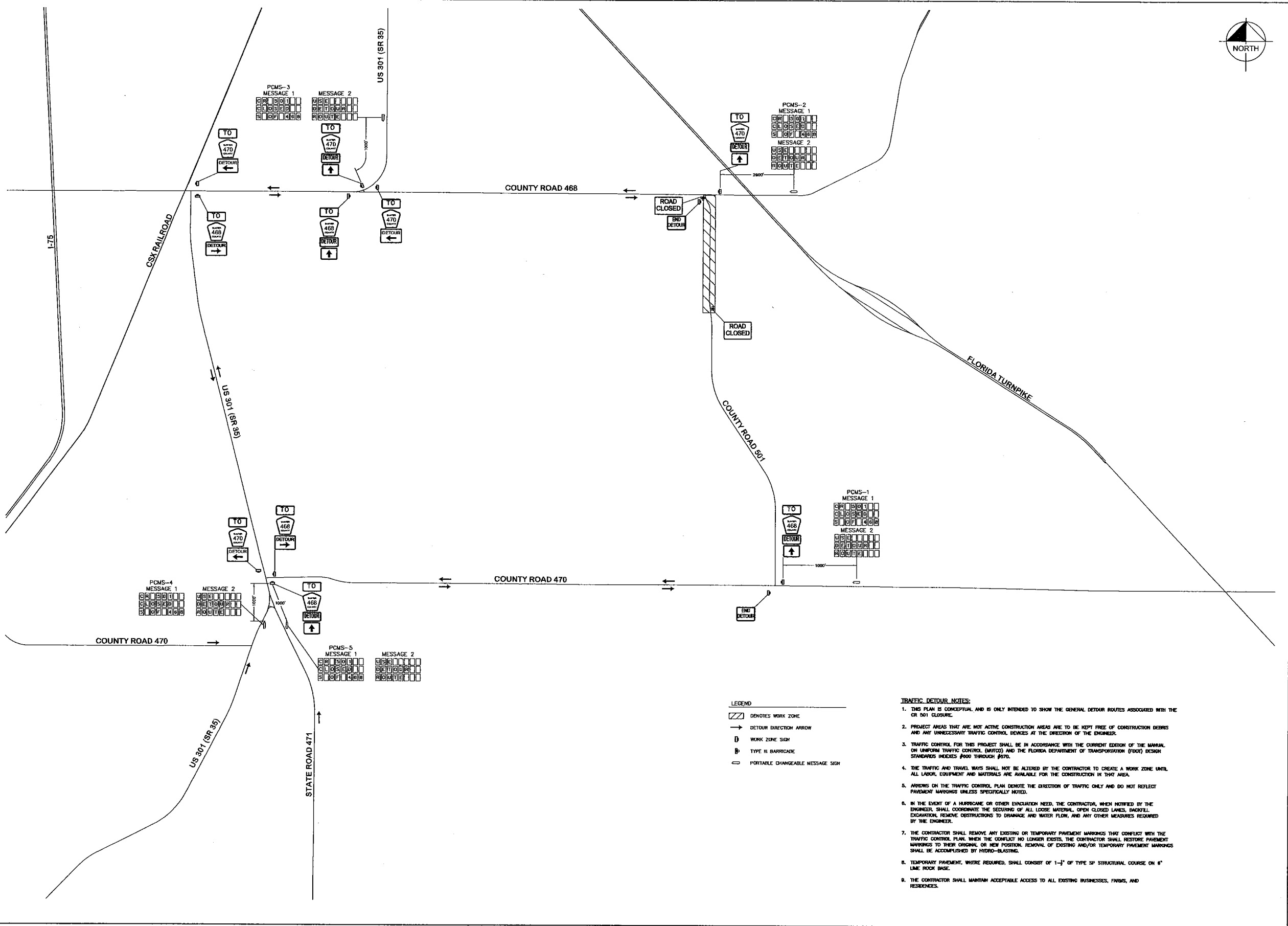

- LEGEND**
- ▨ DENOTES WORK ZONE
 - DETOUR DIRECTION ARROW
 - D WORK ZONE SIGN
 - B TYPE II BARRICADE
 - PORTABLE CHANGEABLE MESSAGE SIGN

- TRAFFIC DETOUR NOTES:**
1. THIS PLAN IS CONCEPTUAL AND IS ONLY INTENDED TO SHOW THE GENERAL DETOUR ROUTES ASSOCIATED WITH THE CR 501 CLOSURE.
 2. PROJECT AREAS THAT ARE NOT ACTIVE CONSTRUCTION AREAS ARE TO BE KEPT FREE OF CONSTRUCTION DEBRIS AND ANY UNNECESSARY TRAFFIC CONTROL DEVICES AT THE DISCRETION OF THE ENGINEER.
 3. TRAFFIC CONTROL FOR THIS PROJECT SHALL BE IN ACCORDANCE WITH THE CURRENT EDITION OF THE MANUAL ON UNIFORM TRAFFIC CONTROL (MUTCD) AND THE FLORIDA DEPARTMENT OF TRANSPORTATION (FDOT) DESIGN STANDARDS SPECIFICATIONS (600 THROUGH 870).
 4. THE TRAFFIC AND TRAVELWAYS SHALL NOT BE ALTERED BY THE CONTRACTOR TO CREATE A WORK ZONE UNLESS ALL LABOR, EQUIPMENT AND MATERIALS ARE AVAILABLE FOR THE CONSTRUCTION IN THAT AREA.
 5. ARROWS ON THE TRAFFIC CONTROL PLAN DENOTE THE DIRECTION OF TRAFFIC ONLY AND DO NOT REFLECT PAVEMENT MARKINGS UNLESS SPECIFICALLY NOTED.
 6. IN THE EVENT OF A HURRICANE OR OTHER EVACUATION NEED, THE CONTRACTOR, WHEN NOTIFIED BY THE ENGINEER, SHALL COORDINATE THE SECURING OF ALL LOOSE MATERIAL, OPEN CLOSED LANES, BACKFILL, EXCAVATION, REMOVE OBSTRUCTIONS TO DRAINAGE AND WATER FLOW, AND ANY OTHER MEASURES REQUIRED BY THE ENGINEER.
 7. THE CONTRACTOR SHALL REMOVE ANY EXISTING OR TEMPORARY PAVEMENT MARKINGS THAT CONFLICT WITH THE TRAFFIC CONTROL PLAN. WHEN THE CONFLICT NO LONGER EXISTS, THE CONTRACTOR SHALL RESTORE PAVEMENT MARKINGS TO THEIR ORIGINAL OR NEW POSITION. REMOVAL OF EXISTING AND/OR TEMPORARY PAVEMENT MARKINGS SHALL BE ACCOMPLISHED BY HYDRO-BLASTING.
 8. TEMPORARY PAVEMENT, WHERE REQUIRED, SHALL CONSIST OF 1-1/2" OF TYPE SP STRUCTURAL COURSE ON 6" LIME ROCK BASE.
 9. THE CONTRACTOR SHALL MAINTAIN ACCEPTABLE ACCESS TO ALL EXISTING BUSINESSES, FARMS, AND RESIDENCES.



CR 501/C-468 TRAFFIC CONTROL	
PREPARED FOR SUMTER COUNTY BOARD OF COUNTY COMMISSIONERS	
FLORIDA SUMTER COUNTY	
SHEET NUMBER 05	
KHA PROJECT 042212085	LICENSED PROFESSIONAL
DATE NOVEMBER 2017	NICHOLAS J. HORA, P.E.
SCALE AS SHOWN	FLORIDA LICENSE NUMBER 70697
DESIGNED BY KHA	DSC
DRAWN BY DSC	NJM
CHECKED BY NJM	DATE
TRAFFIC DETOUR PLAN - PHASE 1	
Kimley-Horn	
© 2017 KIMLEY-HORN AND ASSOCIATES, INC. 101 EAST SILVER SPRING BLVD, SUITE 400, OCALA, FL 34470 PHONE: 352-438-3000 WWW.KIMLEY-HORN.COM CA 00000688	
NOT FOR CONSTRUCTION	
No.	REVISIONS
BY	DATE