

US HWY 27 / 441

FUTURE ROADWAY IMPROVEMENT RECOMMENDATION PER TIA  
NOT INCLUDED IN BJ'S CONSTRUCTION  
(SHOWN IN RED)

PROPOSED PAVEMENT MARKINGS PER BJ'S IMPROVEMENTS  
(SHOWN IN BLUE)

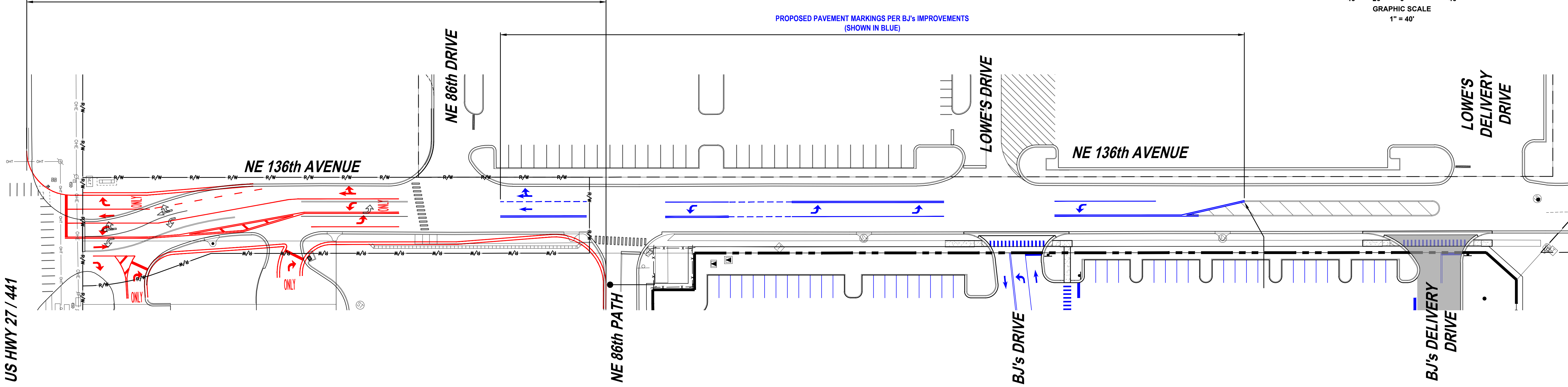
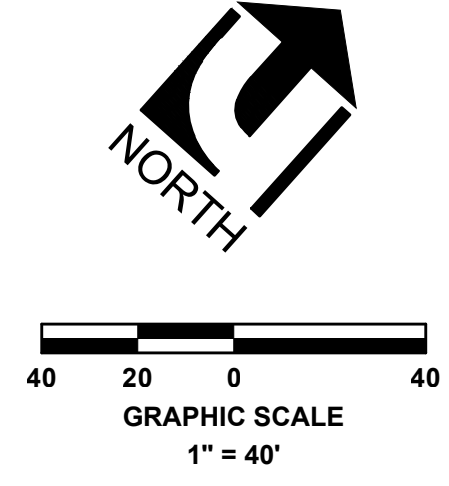

REVISIONS

DATE	DESCRIPTION

THIS ITEM HAS BEEN DIGITALLY  
SIGNED AND SEALED BY  
ROGER W. STROCLA, PE  
ON THE DATE ADJACENT TO THE SEAL  
PRINTED COPIES OF THIS DOCUMENT  
ARE NOT CONSIDERED SIGNED AND  
SEALED AND THE SIGNATURE MUST BE  
VERIFIED ON ANY ELECTRONIC COPIES

**UPHAM**  
CIVIL ENGINEERING-SURVEYING-LANDSCAPE ARCHITECTURE  
265 Kenilworth Avenue • Ormond Beach • Florida 32174  
Voice: 386.672.9515 • Fax: 386.673.6564 • uphaminc.com  
LP # 0003612

THIS DRAWING IS THE PROPERTY  
OF UPHAM, INC. ANY USE OR  
REPRODUCTION IN WHOLE OR PART  
IS PROHIBITED WITHOUT THE  
EXPRESSED WRITTEN CONSENT OF  
UPHAM, INC. COPYRIGHT 2021  
ALL RIGHTS RESERVED

NE 136th AVENUE PLAN  
VILLAGE CROSSING  
LADY LAKE, FLORIDA 32159

PROJECT No:	200601
DATE:	FEBRUARY 2, 2020
DESIGN BY:	RWS
DRAWN BY:	HMT
CHECKED BY:	RWS
SCALE:	AS SHOWN

SHEET NUMBER:  
**EX**